

JET

MBS-1211VDAS
MBS-1213CS

METALWORKING BANDSAW

MBS-1211VDAS...50000433T...1~400V,50Hz

MBS-1213CS.....50000363T...1~400V,50Hz

PARTS LIST

EAC

JPW Tool Group Hong Kong Limited

98 Granville Road, Tsimshatsui East, Kowloon, Hong Kong, PRC

www.jettools.com

Импортер в РФ: ООО «ИТА Технолоджи СПб»

105082, Москва, Переведеновский пер., д. 17

www.jettools.ru

Made in Taiwan / Сделано на Тайване

50000433T / 50000363T

2023-03

Breakdown for Arm Assembly

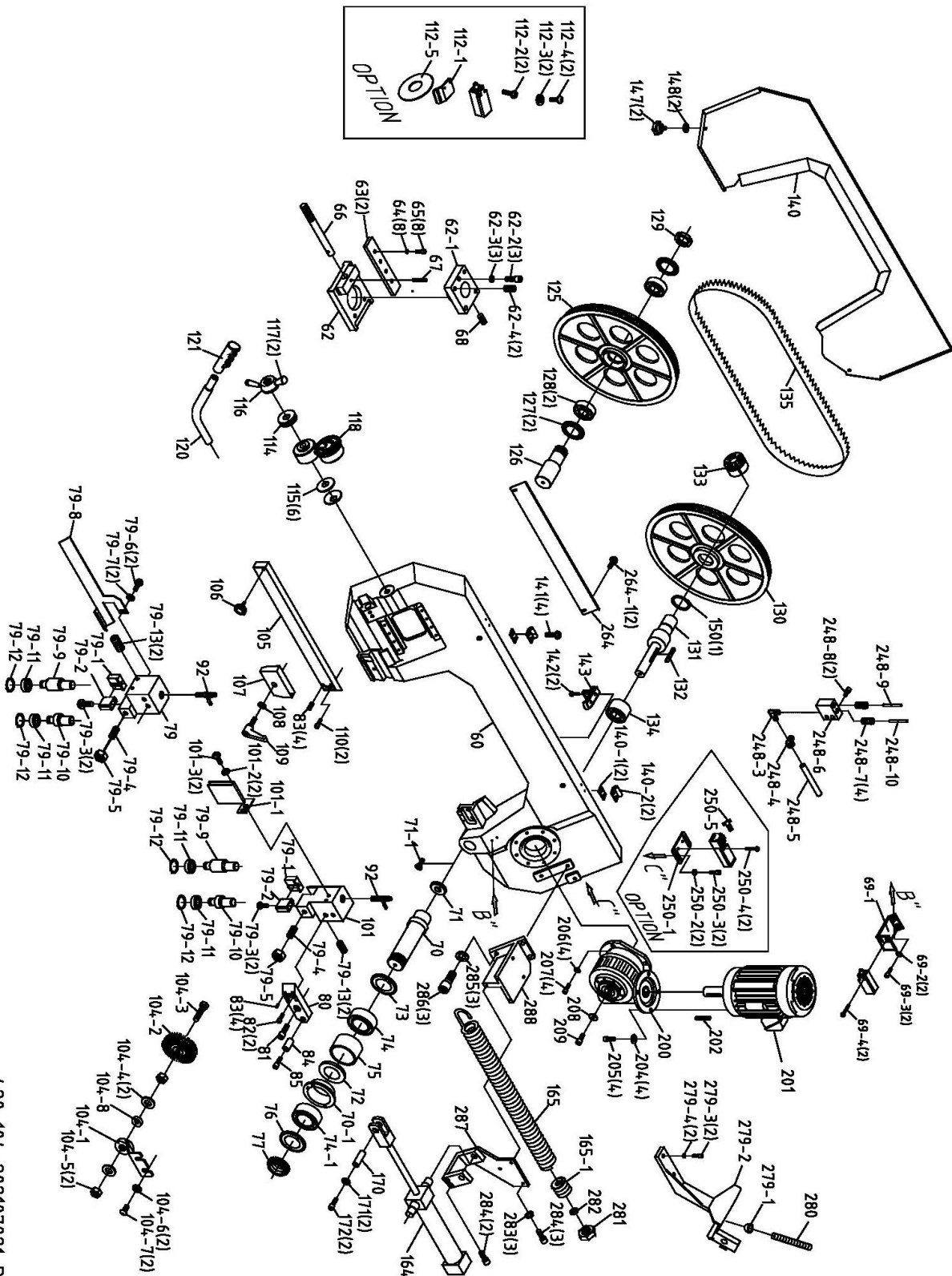

420-104-202107021-R0

Breakdown for Arm Assembly

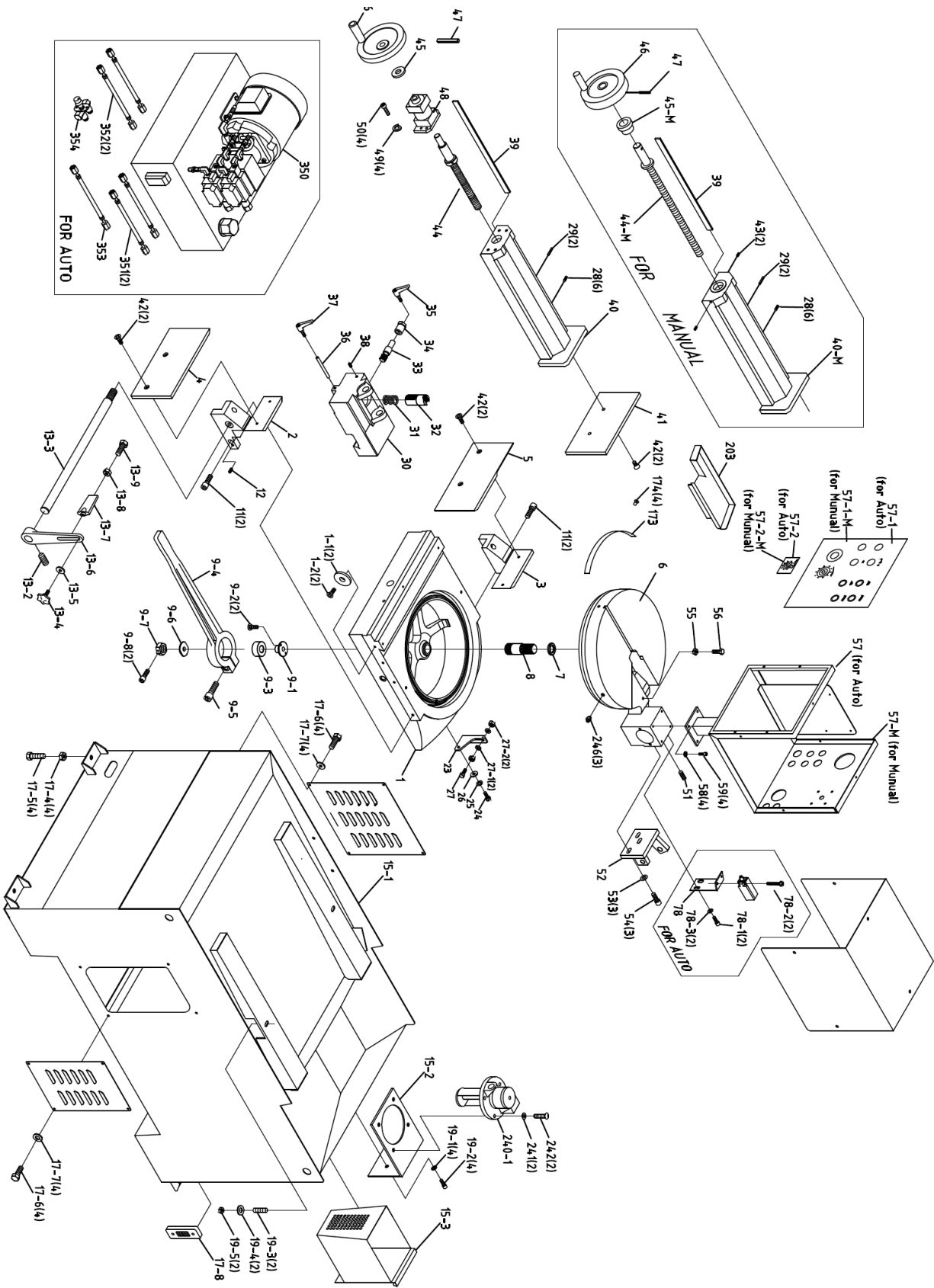

Parts List for MBS-1211VDAS & MBS-1213CS Band saw

Index No.	Part No.	Description	Size	Qty.
1	MBS1211-1	Rotate the base		1
1-1	MBS1211-1-1	Block		2
1-2	MBS1211-1-2	Hex. Socket Flat Head Screw	M8x15L(8*16)	2
2	MBS-1211-2	Regular vice of right		1
3	MBS-1211-3	Regular vice of left		1
4	MBS-1211-4	Right vice splint		1
5	MBS-1211-5	Left vice splint		1
6	MBS-1211-6	Rotate seats		1
7	MBS-1211-7	Nut	AN06 M30*P1.5	1
8	MBS-1211-8	Shaft		1
9-1	MBS-1211-9-1	Bushing		1
9-2	MBS-1211-9-2	Hex. Socket Flat Head Screw	M6x15L	2
9-3	MBS-1211-9-3	Bushing		1
9-4	MBS-1211-9-4	Adjustable Handle		1
9-5	TS-1505051	Hex. Socket Head Screw	M10X35L	1
9-6	MBS-1211-9-6	Bushing		1
9-7	MBS-1211-9-7	Nut	M20	1
9-8	MBS-1211-9-8	Hex. Head Screw	M5x5L	2
11	TS-1506031	Hex. Socket Head Screw	M12x30L	4
12	TS-1526041	Hex. Socker Headless Screw	M12x25L	1
13S	MBS-1211-13S	Length Stop Set		1
13-2	MBS-1211-13-2	Hex. Headless Screw	M6-1.0Px10L	1
13-3	MBS-1211-13-3	Distance Set Rod		1
13-4	MBS-1211-13-4	Plum Screw		1
13-5	TS-0680021	Washer	1/4"x19xt1.5mm	1
13-6	MBS-1211-13-6	Support Rod		1
13-7	MBS-1211-13-7	Distance Set Bracket		1
13-8	MBS-1211-13-8	Hex. Nut	M10-1.5P	1
13-9	TS-1505031	Hex. Socket Head Screw	M10-1.5Px25L	1
15-1	MBS-1211-15-1	Stand		1
15-2	MBS-1211-15-2	Bracket		1
15-3	MBS-1211-15-3	Chip Tray		1
17-4	MBS-1211-17-4	Hex. Nut	M16	4
17-5	MBS-1211-17-5	Hex. Socket Head Screw	M16x50L	4
17-6	MBS-1211-17-6	Round Head Screw	M6X10L	8
17-7	TS-1550041	Washer	6.5*13-0.8t (M6)	8
17-8	MBS-1211-17-8	Oil Meter	PCD=80mm	1
19-1	MBS-1211-19-1	Washer	6.5*13-0.8t (M6)	2
19-2	MBS-1211-19-2	Hex. Socket Head Screw	M6x15L	2
19-3	MBS-1211-19-3	Hex. Socker Headless Screw	M10x40L	2
19-4	TS-1550071	Washer	M10X20Xt2	2
19-5	MBS-1211-19-5	Hex. Nut	M10	2
23	MBS-1211-23	Bracket		1
24	TS-1504041	Hex. Socket Head Screw	M8x20L	1
25	MBS-1211-25	Spring Washer	M8	1
26	TS-1550061	Washer	8.5*18-1.6t (M8)	1
27	TS-1505051	Hex. Socket Head Screw	M10x35L	1
27-1	TS-1550071	Washer	M10X20Xt2	2
27-2	MBS-1211-27-2	Hex. Nut	M10	2
28	MBS-1211-28	Adjustable Screw	M6*35L	6
29	MBS-1211-29	Pin	⌀ 6x25L	2
30	MBS-1211-30	Movable Table		1
31	MBS-1211-31	Spring		1
32	MBS-1211-32	Rack Shaft		1
33	MBS-1211-33	Gear Shaft		1

Index No.	Part No.	Description	Size	Qty.
34	MBS-1211-34	Shaft Bushing		1
35	MBS-1211-35	Grip		1
36	MBS-1211-36	Shaft		1
37	MBS-1211-37	Grip		1
38	TS-1524041	Hex. Socker Headless Screw	M8x16L	1
39	MBS-1211-39	Plate		1
40	MBS-1211-40	Vise Jaw Bracket(Front)		1
40-M	MBS-1213-40	Vise Jaw Bracket(Front)		1
41	MBS-1211-41	Vise Plate		1
42	MBS-1211-42	Flat Head Screw	M8x15L(8*16)	6
43	MBS-1213-43	Hex. Socker Headless Screw	M6xP1.0x20L	2
44	MBS-1211-44	Leadscrew		1
44-M	MBS-1213-44	Leadscrew		1
45	TS-155010	Washer	16*30-3	1
45-M	MBS-1213-45	Presure		1
46	MBS-1211-46	Wheel		1
47	MBS-1211-47	Pin	ϕ 5x30L	1
48	MBS-1211-48	Cylinder		1
49	MBS-1211-49	Spring Washer	M8	4
50	TS-1504061	Hex. Socket Head Screw	M8-1.25Px30L	4
51	TS-1524041	Hex. Socker Headless Screw	M8x16L	1
52	MBS-1211-52	Bracket		1
53	TS-1550071	Washer	M10X20Xt2	3
54	TS-1505041	Hex. Socket Head Screw	M10x30L	3
55	MBS-1211-55	Hex. Nut	M12	1
56	TS-1506071	Hex. Socket Head Screw	M12x50L	1
57	MBS-1211-57	Control Box Assembly		1
57-1	MBS-1211-57-1	Lable for Name Plate		1
57-2	MBS-1211-57-2	Sticker		1
57-M	MBS-1213-57	Control Box Assembly		1
57-1-M	MBS-1213-57-1	Lable for Name Plate		1
57-2-M	MBS-1213-57-2	Sticker		1
58	TS-1550061	Washer	8.5*18-1.6t (M8)	4
59	TS-1504051	Hex. Socket Head Screw	M8x25L	4
60	MBS-1211-60	Saw Frame		1
62	MBS-1211-62	Anchor Block		1
62-1	MBS-1211-62-1	Support Lump		1
62-2	TS-1505051	Hex. Socket Head Screw	M10x35L	3
62-3	MBS-1211-62-3	Spring Washer	M10	3
62-4	TS-1525041	Hex. Headless Screw	M10x20L	2
63	MBS-1211-63	Bushing		2
64	TS-2361081	Spring Washer	M8	8
65	TS-1504051	Hex. Socket Head Screw	M8x25L	8
66	MBS-1211-66	Blade Tension Bar		1
67	MBS-1211-67	Pin	ϕ 6x45L	1
68	TS-1524051	Hex. Socker Headless Screw	M8x20L	1
69-1	MBS-1211-69-1	Switch (For CE Only) Bracket		1
69-2	TS-1550031	Washer	M5	2
69-3	MBS-1211-69-3	Cross Round Head Screw	M5-0.8P*8L	2
69-4	MBS-1211-69-4	Cross Round Head Screw	M4x30L	2
70	MBS-1211-70	Shaft	S45C 376th	1
70-1	MBS-1211-70-1	Bushing		1
71	MBS-1211-71	Plate	S45C 376th	1
71-1	MBS-1211-71-1	Hex.Flat Head Screw	M8x15L(8*16)	1

Index No.	Part No.	Description	Size	Qty.
72	MBS-1211-72	Bearing Spacer	S45C 376th	1
73	MBS-1211-73	Dust Cover		1
74	MBS-1211-74	Bearing	32009J	1
74-1	MBS-1211-74-1	Bearing	32008	1
75	MBS-1211-75	Bushing		1
76	MBS-1211-76	Dust Cover	32008	1
77	MBS-1211-77	Nut	M40*P1.5	1
78	MBS-1211-78	Bracket		1
78-1	MBS-1211-78-1	Hex. Socket Head Screw	M6x15L	2
78-2	MBS-1211-78-2	Cross Round Head Screw	M4x30L	2
78-3	TS-1550041	Washer	6.5*13-0.8t (M6)	2
79	MBS-1211-79	Blade Adjust (Front)		1
79-1	MBS-1211-79-1	Guide		2
79-2	MBS-1211-79-2	Guide		2
79-3	MBS-1211-79-3	Round Head Screw	M6X30L	4
79-4	TS-1524051	Hex. Socker Headless Screw	M8X20L	2
79-5	MBS-1211-79-5	Hex. Nut	M8XP1.25	2
79-6	MBS-1211-79-6	Round Head Screw	M6X10L	1
79-7	TS-1550031	Washer	M5	2
79-8	MBS-1211-79-8	Blade Cover (Front)		1
79-9	MBS-1211-79-9	Eccentric Guide		2
79-10	MBS-1211-79-10	Eccentric Guide		2
79-11	MBS-1211-79-11	Bearing	608-ZZ	4
79-12	MBS-1211-79-12	C-Retainer Ring	§ 8.	4
79-13	MBS-1211-79-13	Round Head Screw	M6X6L	4
80	MBS-1211-80	Blade adjust stick		1
81	TS-1506031	Hex. Socket Head Screw	M12x30L	1
82	TS-1504061	Hex. Socket Head Screw	M8x30L	2
83	MBS-1211-83	Hex. Socker Headless Screw	M6-1.0Px15L	8
84	MBS-1211-84	Release Block		1
85	TS-1506091	Hex. Socket Head Screw	M12x60L	1
89	MBS-1211-89	Upper Bracket		1
89-1	MBS-1211-89-1	Knob		1
89-2	MBS-1211-89-2	Shaft		1
89-3	TS-1503071	Hex. Socket Head Screw	M6x30L	2
89-4	TS-1550041	Washer	6.5*13-0.8t (M6)	2
92	MBS-1211-92	Hose Fitting	§ 6X1/8"PT	2
101	MBS-1211-101	Blade Adjustable (Rear)		1
101-1	MBS-1211-101-1	Blade Cover		1
101-2	TS-1550031	Washer	M5	2
101-3	MBS-1211-101-3	Round Head Screw	M5X12L	2
104-1	MBS-1211-104-1	Brush Bracket		1
104-2	MBS-1211-104-2	Brush		1
104-3	TS-1503071	Hex. Socket Head Screw	M6x30L	1
104-4	TS-1550041	Washer	ø6.5Xø18Xt1.5mm	2
104-5	MBS-1211-104-5	Hex. Nut	M6	2
104-6	MBS-1211-104-6	Washer	M5	2
104-7	MBS-1211-104-7	Cross Round Head Screw	M5-0.8P*8L	2
105	MBS-1211-105	Blade adjust stick		1
106	MBS-1211-106	Plum handle	M8	1
107	MBS-1211-107	Fix Block		1
108	TS-2360121	Washer	M12X23Xt2	1
109	MBS-1211-109	Grip		1
110	TS-1504061	Hex. Socket Head Screw	M8x30L	2
112-1	MBS-1211-112-1	Bracket		1

Index No.	Part No.	Description	Size	Qty.
112-2	MBS-1211-112-2	Cross Round Head Screw	M4x28L	2
112-3	TS-1550031	Washer	M5	2
112-4	MBS-1211-112-4	Hex. Socket Head Screw	M5X15L	2
112-5	MBS-1211-112-5	Press board		1
114	MBS-1211-114	Bearing	51203	1
115	MBS-1211-115	Spring Washer		6
116	MBS-1211-116	Blade Tension Handle		1
117	MBS-1211-117	Knob		2
118	MBS-1211-118	Scale		1
120	MBS-1211-120	Connecting Tube		1
121	MBS-1211-121	Handle Cap		1
125	MBS-1211-125	Idler Wheel		1
126	MBS-1211-126	Shaft Assembly		1
127	MBS-1211-127	Dust Cover		2
128	MBS-1211-128	Bearing	32007J	2
129	MHBS-1211-129	Nut	AN07 M35*P1.5	1
130	MBS-1211-130	Drive Wheel		1
131	MBS-1211-131	Drive Gear Shaft		1
133	MBS-1211-133	Shaft Bushing		1
134	BB-6307ZZ	Bearing	#6307ZZ	1
135	MBS-1211-135	Blade (4/6T(HHS))	3320x27x0.9,,	1
138	TS-2361121	Spring Washer	M12	4
140	MBS-1211-140	Frame Cover		1
140-1	MBS-1211-140-1	Washer		2
140-2	MBS-1211-140-2	flexible plate		2
141	MBS-1211-141	Cross Round Head Screw	M6-1.0P*16L	4
142	MBS-1211-142	Cross Round Head Screw	M5-0.8P*8L	2
143	MBS-1211-143	Ring		1
147	MBS-1211-147	Plum Screw	M6*13	2
148	TS-1550041	Washer	6.5*13-0.8t (M6)	2
149	TS-2361121	Spring Washer	M12	4
150	MBS-1211-150	C-Retaniner Ring	S35	2
163	TS-1504051	Hex. Socket Head Screw	M8x25L	2
164	MBS-1211-164	Cylinder Assembly		1
164-M	MBS-1213-164	Cylinder Assembly		1
165	MBS-1211-165	Spring		1
165-1	MBS-1211-165-1	Bushing		1
170	MBS-1211-170	Shaft		1
171	TS-1550061	Washer	8.5*18-1.6t (M8)	2
172	MBS-1211-172	Hex. Socket Head Screw	M8x15L	2
173	MBS-1211-173	Scale		1
174	MBS-1211-174	Rivet	§ 2	2
200	MBS-1211-200	Gear Box	#63,,E=1/40,,	1
201	MBS-1211-201	Motor (4P)	2HP/400V/50HZ/3PH	1
201-M	MBS-1213-201	Motor (2/4P)	2HP/400V/50HZ/3PH	1
202	MBS-1211-202	Key	8X7X40L	1
203	MBS-1211-203	Fluid Collected Plate		1

Index No.	Part No.	Description	Size	Qty.
204	TS-2361081	Spring Washer	M8	4
205	TS-1504051	Hex. Socket Head Screw	M8x25L	4
206	TS-1550071	Washer	M10x27x2T	4
207	TS-1505031	Hex. Socket Head Screw	M10x1.5Px25L	4
208	MBS-1211-208	Prive Shaft Washer		1
209	TS-1505021	Hex. Socket Head Screw	M10-1.5Px20L	1
210	MBS-1211-210	Reducer Cover		1
211	MBS-1211-211	Hex. Socket Head Screw	M8x15L	2
240-1	MBS-1211-240-1	Cooling Pump Assembly	1/8HP, 1ph, 400V	1
241	TS-2361061	Spring Washer	M6	2
242	MBS-1211-242	Hex. Socket Head Screw	M6-1.0Px15L	2
246	MBS-1211-246	Grease Nipple	PT1/8	3
248-3	MBS-1211-248-3	Micro Control Block	PT1/4"x1/2"	1
248-4	MBS-1211-248-4	Hose Clamp	§ 19	1
248-5	MBS-1211-248-5	Net Tube	ID1/2"x2.8tx320cm	1
248-6	MBS-1211-248-6	3 Way Valve		1
248-7	MBS-1211-248-7	Hose Fitting	§ 6X1/8"PT	4
248-8	TS-1503071	Hex. Socket Head Screw	M6x30L	2
248-9	MBS-1211-248-9	PU Tube	§ 6x240L	1
248-10	MBS-1211-248-10	PU Tube	§ 6x240L	1
250-1	MBS-1211-250-1	Micro Switch Bracket		1
250-2	TS-1550031	Washer	M5	2
250-3	MBS-1211-250-3	Hex. Socket Head Screw	M5X15L	2
250-4	MBS-1211-250-4	Cross Round Head Screw	M4x30L	2
250-5	MBS-1211-250-5	Switch Plate		1
264	MBS-1211-264	Cable Cover		1
264-1	MBS-1211-264-1	Cross round head screw	M6-1.0x16L	2
279-1	MBS-1211-279-1	Round washer		1
279-2	MBS-1211-279-2	Spring bracket		1
279-3	MBS-1211-279-3	Hex. Socket head screw	M12x35L	2
279-4	MBS-1211-279-4	Spring washer	M12	2
280	MBS-1211-280	Screw rod	M10x180L	1
287	MBS-1211-287	Clinder bracket		1
288	MBS-1211-288	Spring base		1
350	MBS-1211-350	hydraulic unit		1
351	MBS-1211-351	Tube	1/4"x3600mm	2
352	MBS-1211-352	Tube	1/4"x2100mm	2
353	MBS-1211-353	Tube	1/4"x800mm	1
354	MBS-1211-354	throttle valve		1

MBS1211VDAS...50000433T...1~400V,50Hz

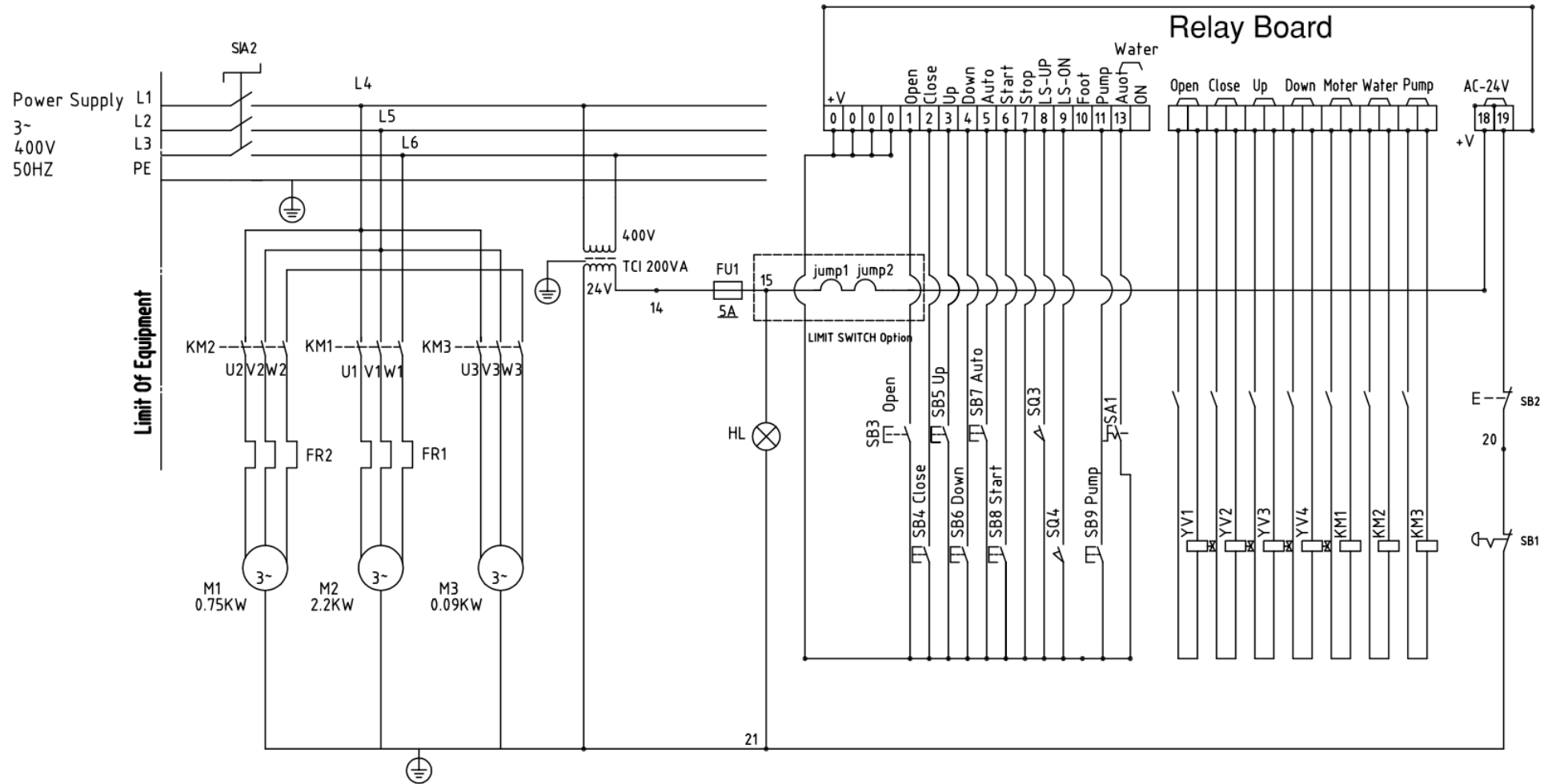

MBS-1211VDAS		SCHEDULE OF ELECTRICAL EQUIPMENT			
Item.	Designation and function	Technical data	QTY	Supplier reference	Remark
SA1	PUMP SWITCH	NSS22-S-2A	1	NHD	
KM1	Main Motor Contactor		1		
KM2	Oil Motor Contactor		1		
KM3	Pump Contactor		1		
FR1	MOTOR OVERLOAD		1		
FU1	Fuse 5A		1		
TCI	Transformer	0.400V/24V	1	LCE	
YV1	Vice Valve ON		1		
YV2	Vice Valve OFF		1		
YV3	Up Valve		1		
YV4	Down Valve		1		
HL	Singal	NLD-22	1	NHD	
SB1	Emergency Stop Switch		1	KD	
SB2	OFF Switch	HY57B E195428	1	NHD	
SB3	Vice ON Switch	NPB22-F10G	1	NHD	
SB4	Vice OFF Switch	NPB22-F10R	1	NHD	
SB5	UP Switch	NPB22-F10G	1	NHD	
SB6	Down Switch	NPB22-F10G	1	NHD	
SB7	Auto Mode	NSS22-S-1A	1	NHD	
SB8	Motor Start Switch	NPB22-F10G	1	NHD	
SB9	Oil Pump Switch	NPB22-F10G	1	NHD	
SQ3	Lower Limit Switch	AZD-1112	1	Shinozaki	
SQ4	Upper Limit Switch	AZD-1112	1	Shinozaki	
M1	Motor	3/400/4P/3PH	1	JIUH DAH	
M2	Oil Motor	1/400/4P/3PH	1		
M3	Water Motor	1/8/400/3PH	1	JIUH DAH	
FR2	OIL PUMP OVERLOAD		1		
SA2	MAIN POWER SWITCH		1		
JUMP1	LIMIT SWITCH		1	OPTIONAL	
JUMP2	LIMIT SWITCH		1	OPTIONAL	

MBS1213CS...50000363T...1~400V,50Hz

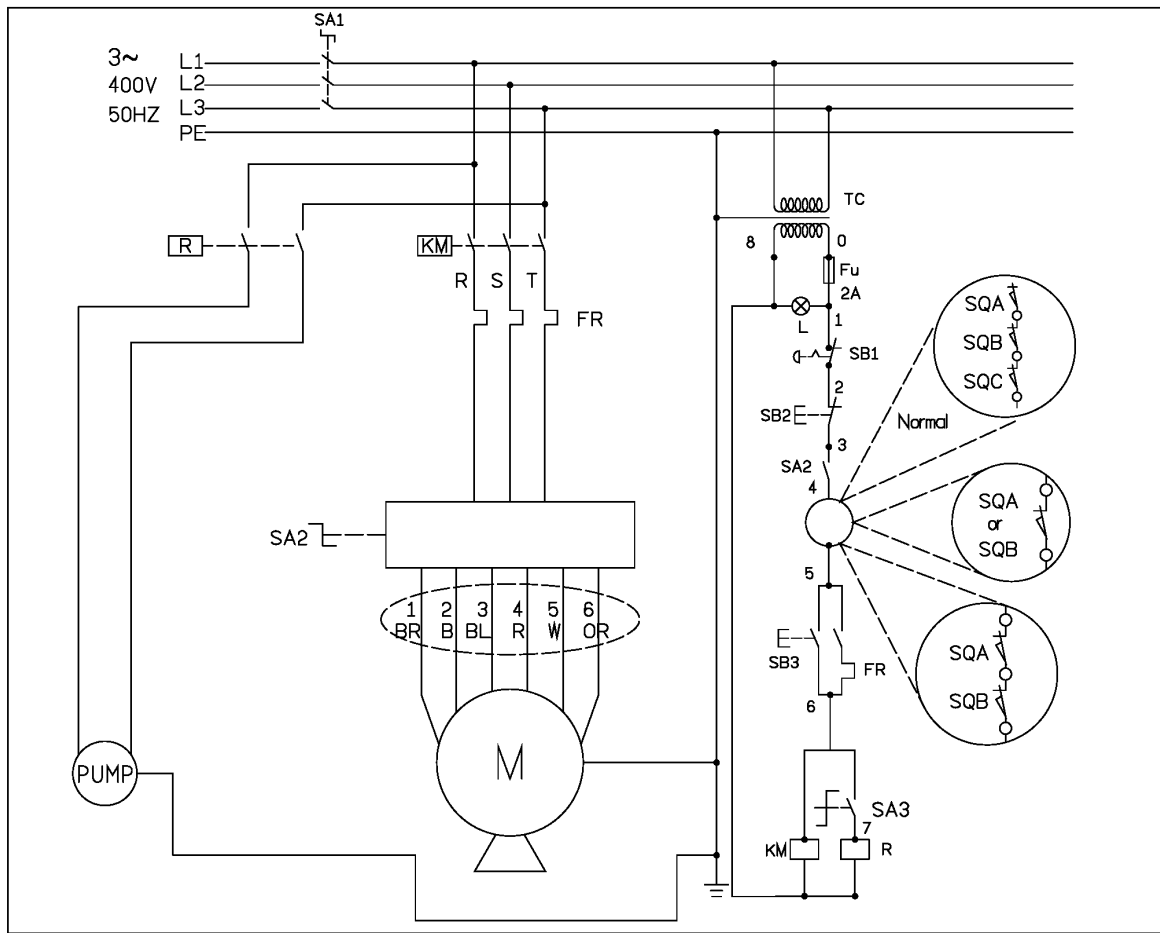

SCHEDULE OF ELECTRICAL EQUIPMENT

Item.	Designation and function	Technical data	QTY
KM	Contactora	c-06d10a7	1
FU	Fuse base		4
FUSE	2A		2
TC	Transformer	30VA G,0,230V/400V,0,24V	1
L	Power light		1
FR	Over Load	4.8A	1
R	RELAY		1
SA1	Power switch		1
SA2	2/4P switch	C-172-48x48	1
SB1	Emergency stop button	HY-57B	1
SB3	Start Switch		1
SA3	Pump Switch		1
SQA	Cover Limit switch		1
SQB	Lower Limit switch		1
SB2	Off Switch		1
SQC	Tension Switch		1